

# Miniature Force Load Cell



## Features

Capacity 2N,3N,5N,10N,20N,30N,50N

Compact size

Stainless steel construction

Both compression and tension

## Optional features

0-5V, 4-20mA output signal

## DESCRIPTION

ZMMA-CS is configured for compression and tension force measurement. Full-bridge, bonded foil strain gauge technology provides excellent long-term stability and ensures high performance even in applications requiring in excess of 1 million load cycles. Constructed from stainless steel and protected from moisture with an epoxy bonded cover. Small diameter and compact size make ZMMA-CS widely used on robots and automation small force test.

## DIMENSIONS

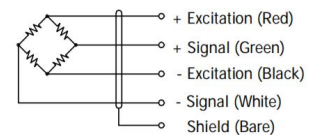
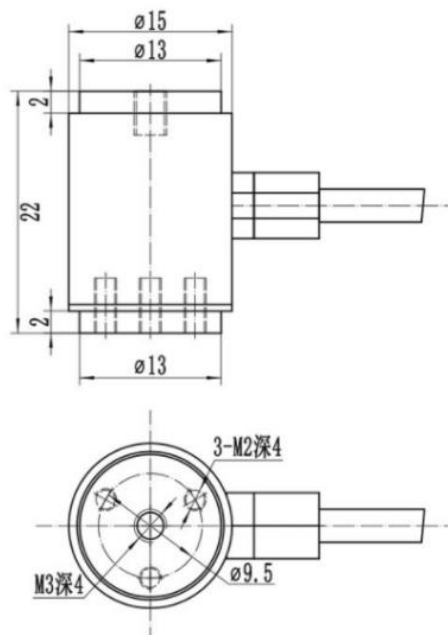

## SPECIFICATIONS

PARAMETER	VALUE	UNIT
Standard capacities (E <sub>max</sub> )	2,3,5,10,20,30,50	N
Rated output-R.O.	1.0	mV/V
Zero balance	1	±% of rated output
Non linearity	0.3	±% of rated output
Hysteresis	0.3	±% of rated output
Non-repeatability	0.2	±% of rated output
Creep error (30 minutes)	0.05	±% of rated output
Zero return (30 minutes)	0.03	±% of rated output
Temperature effect on min. dead load output	0.0026	±% of rated output/°C
Temperature effect on sensitivity	0.0015	±% of rated output/°C
Compensated temperature range	-10 to +40	°C
Operating temperature range	-20 to +60	°C
Safe overload	150	% of R.C
Ultimate overload	200	% of R.C
Excitation, recommended	10	Vdc
Excitation, maximum	15	Vdc
Input resistance	370±20	Ohms
Output resistance	350±3	Ohms
Insulation resistance	5000	Mega-Ohms
Material	Stainless steel	
Protection class	IP66	

All specifications listed subject to change without notice.